

# DOSING PUMPS mROY® XT / XW



mROY® Extended range for high pressures  
Flow rate up to 29 l/h - Pressure up to 206 bar  
Hydraulic by-pass system / hydraulically actuated diaphragm

## Serie XT

- Flow rate up to 10 l/h
- Pressure up to 206 bar

## Serie XW

- Flow rate up to 29 l/h
- Pressure up to 206 bar

## Main technical characteristics

- Manual capacity adjustment from 0 to 100%
- $\pm 0.5\%$  steady state accuracy over a turndown ratio of 8:1
- Hydraulically actuated PTFE disc diaphragm
- High performance check valves
- Stainless steel liquid end components
- Integral relief valve
- Process side gas bleed (standard)
- High quality chemical resistant Polyurethane coating RAL 1018
- Conformity with the API 675 Standard
- Option: double diaphragm on request



## Summary specifications

	mROY® XT	mROY® XW
Liquid End Assembly Material	316 Stainless Steel	316 Stainless Steel
Diaphragm Material	PTFE	PTFE
Balls and seats (standard)	316	316
Plunger Diameter	3/8" (9.52 mm)	1/2" (12.7 mm)
Capacity Control	Micrometer (Std.)	Micrometer (Std.)
Check valve configuration	double ball	double ball
Flow range @ 10 bar service (100%)	1.5 - 8.2 l/h	8.9 - 29 l/h
Flow range @ 206 bar service (100%)	1.1 - 5.8 l/h	7.7 - 25 l/h
Swept volume	1.2 cm <sup>3</sup>	4.0 cm <sup>3</sup>
Equivalent Stroke Length (adjustable)	0 - 17.8 mm	0 - 31.8 mm
Liquid Temperature Limits	- 5 to 95°C	- 5 to 95°C
Max. Allowable Suction Pressure	206 bar	206 bar
Suction Lift (of H <sub>2</sub> O)	3 m. MLC	1.5 m. MLC
Factory Relief Valve Setting (standard)	Adjustable from 10 to 240 bar	Adjustable from 10 to 240 bar
Motor Horsepower Simplex	0.25 kW (0.37 kW for 152 spm)	0.55 kW
Motor speed	1500 rpm	1500 rpm
Flange	F130	F165
Frame	71	80
Shaft	14x30	19x40

## Electrical characteristics of motors

- Power supply:  
- 230/400 V - 50 Hz 3-phases - 1500 rpm
- Degree of protection: IP55, tropicalized motor
- Insulation: class F
- API flange mounting: on request for XT and standard for XW
- Explosion-proof motor or frequency variation available on request

## XT SERIE Dimensions (mm) & Connections

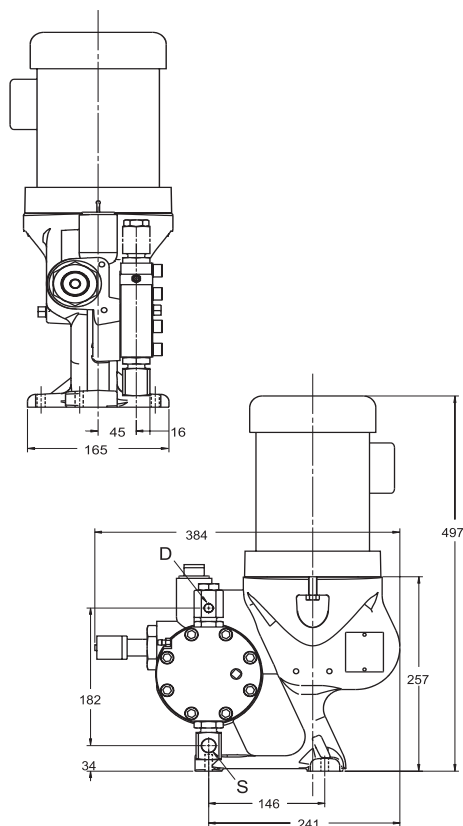

S = Suction - 1/2" NPT female  
D = Discharge - 1/4" NPT female  
• Flange connections on request

## Weight and packing

	Net weight <sup>(1)</sup> kg	Gross weight <sup>(1)</sup> kg	Packing <sup>(2)</sup> (LxH) mm
mROY® XT	27	40	385x165x495
mROY® XW	54	70	570x215x705

<sup>(1)</sup> Approximately - <sup>(2)</sup> Standard cardboard packing

## XW SERIE Dimensions (mm) & Connections

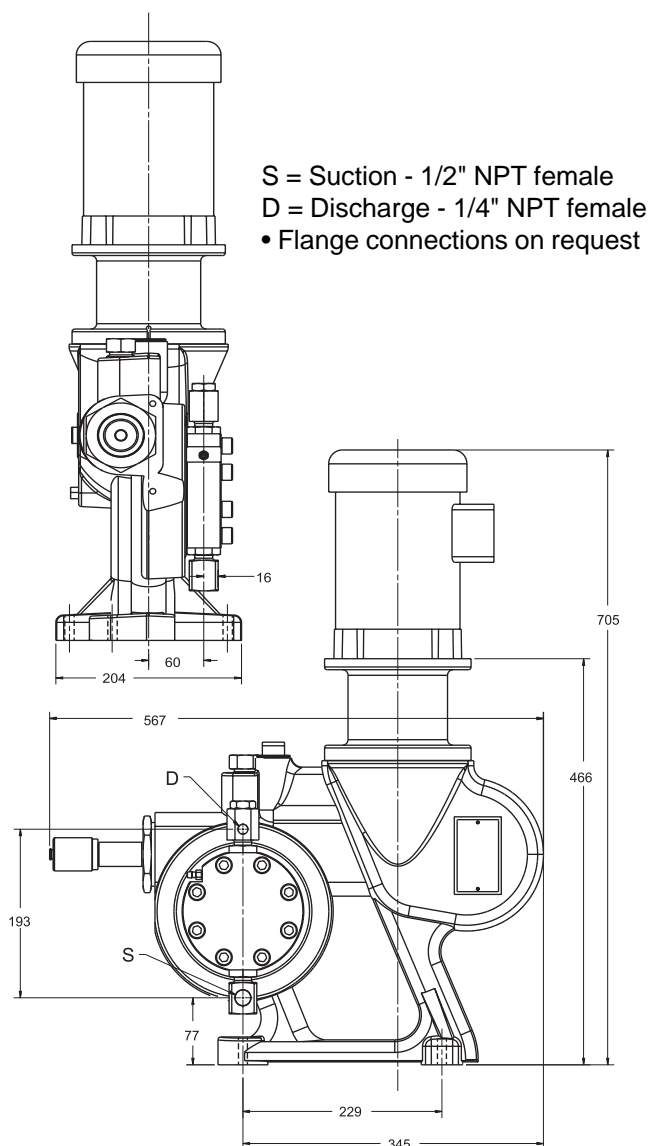

S = Suction - 1/2" NPT female  
D = Discharge - 1/4" NPT female  
• Flange connections on request



**FRANCE - DOSAPRO MILTON ROY S.A.**  
10, Grande Rue - 27360 Pont Saint Pierre  
Tél. : +33 (0)2 32 68 30 00 - Fax : +33 (0)2 32 68 30 93  
<http://www.dosapro.com> - Telex : 180 345F  
e-mail : [contact@dosapro.com](mailto:contact@dosapro.com)

**ESPAÑA - DOSAPRO MILTON ROY IBERICA**  
C/Embajadores, 100 - 28012 MADRID  
Tél. : +34 91 517 80 00 - Fax : +34 91 517 52 38  
<http://www.dosapro.es>

**UNITED KINGDOM - MILTON ROY (UK) LTD**  
Oaklands Business Centre - Oaklands Park  
WOKINGHAM - BERKSHIRE - RG41 2FD  
Tel : +44 118 977 1066 - Fax : +44 118 977 1198  
<http://www.miltonroypumps.co.uk>

**INTERNATIONAL SALES and PROJECTS DEPARTMENT**  
10, Grande Rue - 27360 Pont Saint Pierre (France)  
Tél. : +33 (0)2 32 68 30 12 - Fax : +33 (0)2 32 68 30 91 - Télex : 180 345F

**SPARE PARTS DEPARTMENT/PIÈCES DE RECHANGE**  
10, Grande Rue - 27360 Pont Saint Pierre (France)  
Tél. +33 (0)2 32 68 30 01 - Fax: +33 (0)2 32 68 30 92 - Télex : 180 345F

**INTERNATIONAL TECHNICAL ASSISTANCE/ASSISTANCE TECHNIQUE**  
10, Grande Rue - 27360 Pont-Saint-Pierre (France)  
Tel : +33 (0)2 32 68 30 02 - Fax : +33 (0)2 32 68 30 92 - Télex : 180 345F

**DOSAPRO MILTON ROY EN FRANCE :**  
Angers, Bordeaux, Lille, Lyon, Nancy, Paris, Rouen